

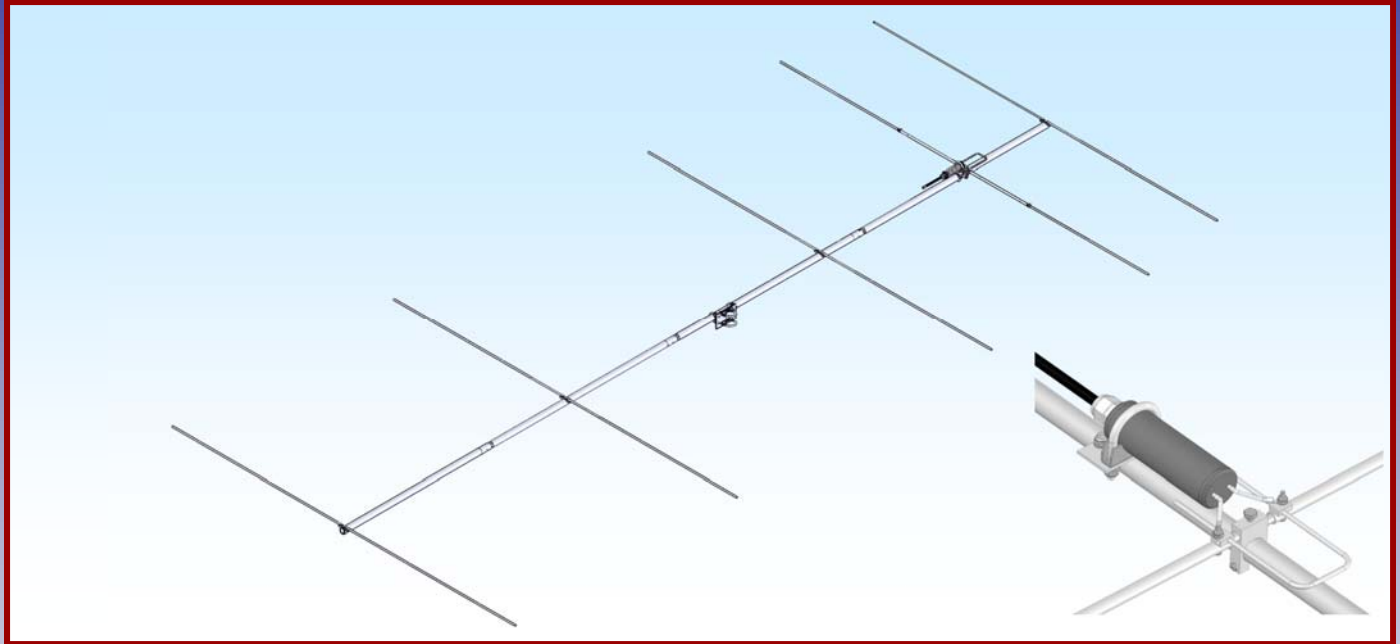

M2 Antenna Systems, Inc.

Model No: 6M5XHP



SPECIFICATIONS:

Model	6M5XHP	Power Handling	1.5 kW, Higher avl.
Frequency Range.....	50.0 To 50.5 MHz	Boom Length / Dia.....	216" / 1-1/2"
*Gain, (FS)f	11.54 dBi	Maximum Element Length.....	113"
Front to back	21 dB Typical	Turning Radius:	134"
Beamwidth	E=42° H=52°	**Stacking Distance.....	15'-21'H & 19'-23' W
Feed type	Direct feed	Mast Size.....	1-1/2" to 2" Nom.
Feed Impedance.	50 Ohms Unbalanced	Wind area / Survival	2.2 Sq. Ft. / 100 MPH
Maximum VSWR.....	1.1 @ 50.175	Weight / Ship Wt.....	13 Lbs. / 16 Lbs.
Input Connector.....	SO-239		

***Subtract 2.14 from dBi for dBd / FS = Free Space / ** H = High / W = Wide**

FEATURES:

The 6M5XHP is the latest computer optimized version of our popular 6M5X. The 6M5XHP has been re-designed to use a hairpin type direct feed. We just made a good thing better, maintaining a low wind load and great performance for its size. The 6M5XHP will compliment the rest of your antenna system and not overload your tower. The 6M5XHP is perfect for the Ham trying 6 meters for the first time or the seasoned vet who may stack them for lower angle of radiation or even some EME use.

6M5XHP DIMENSION SHEET

TOOLS REQUIRED: Screwdriver, 11/32 wrench, socket or spintite, a 7/16" and 1/2" wrench or socket, tape measure.

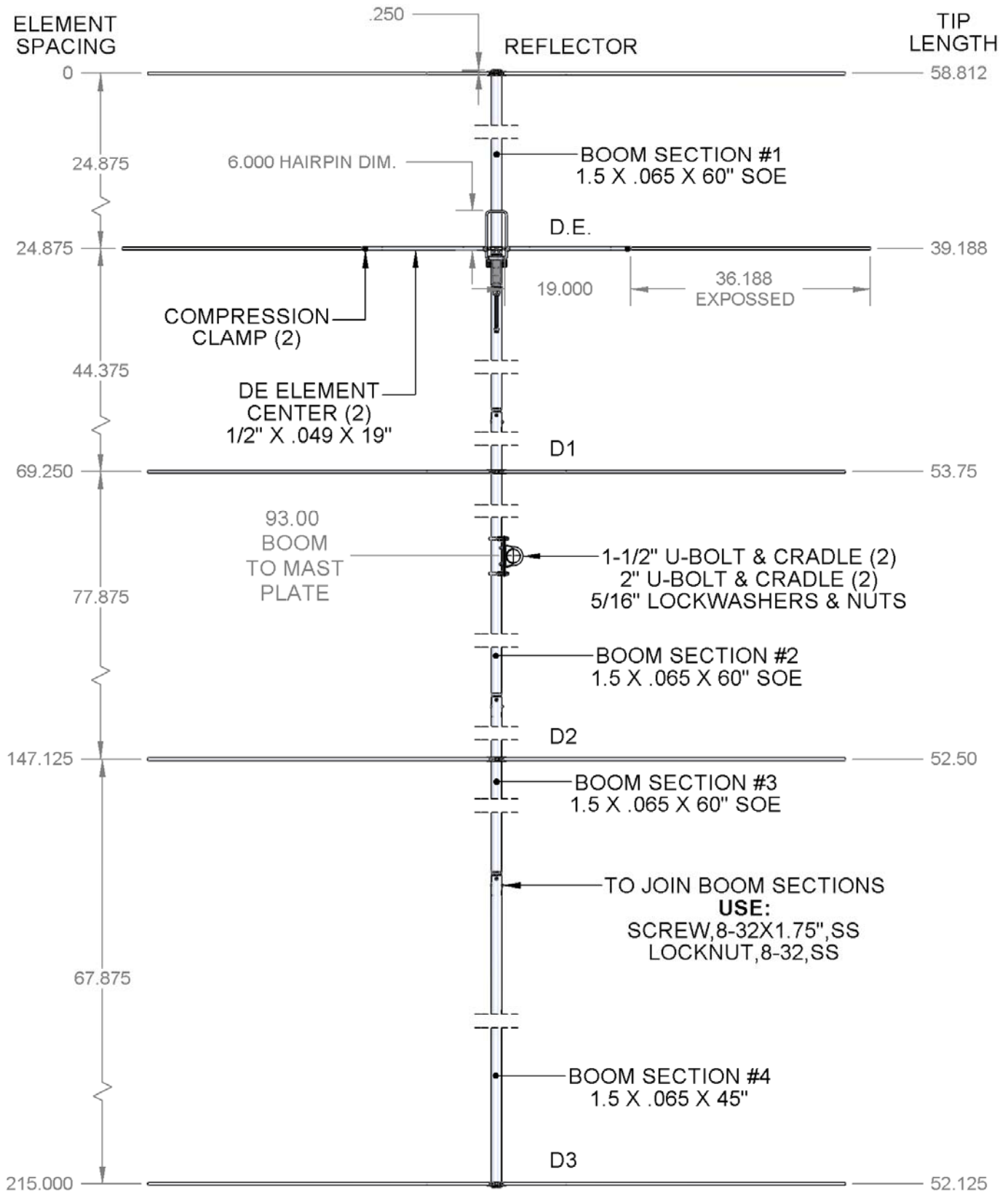

****Please be sure to slip Driven Element Clamp Block on to the boom before adding the next boom section****

6M5XHP BALUN DETAIL

NOTE:
UNIVERSAL BALUN LEADS
ARE LONG FOR OTHER ANTENNAS
PLEASE CUT LEADS DOWN TO 1.25"
AND STRIP .25" OF EACH END &
SOLDER LUGS TO EACH END.

NOTE:
3/8" ELEMENT TIP
SHOWN TRANSPARENT
TO SHOW INTERNAL
ELEMENT SUPPORT ROD

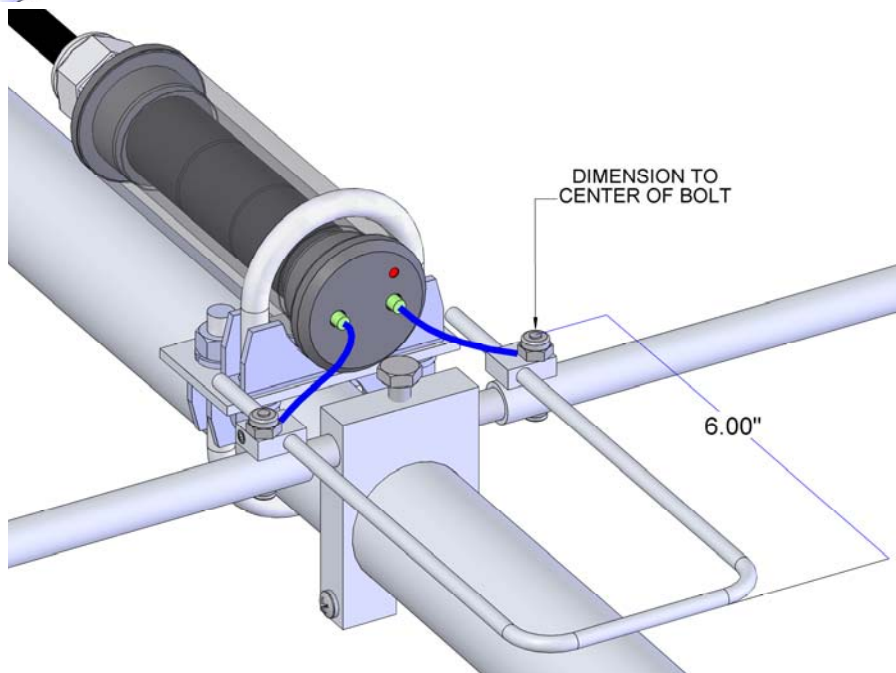
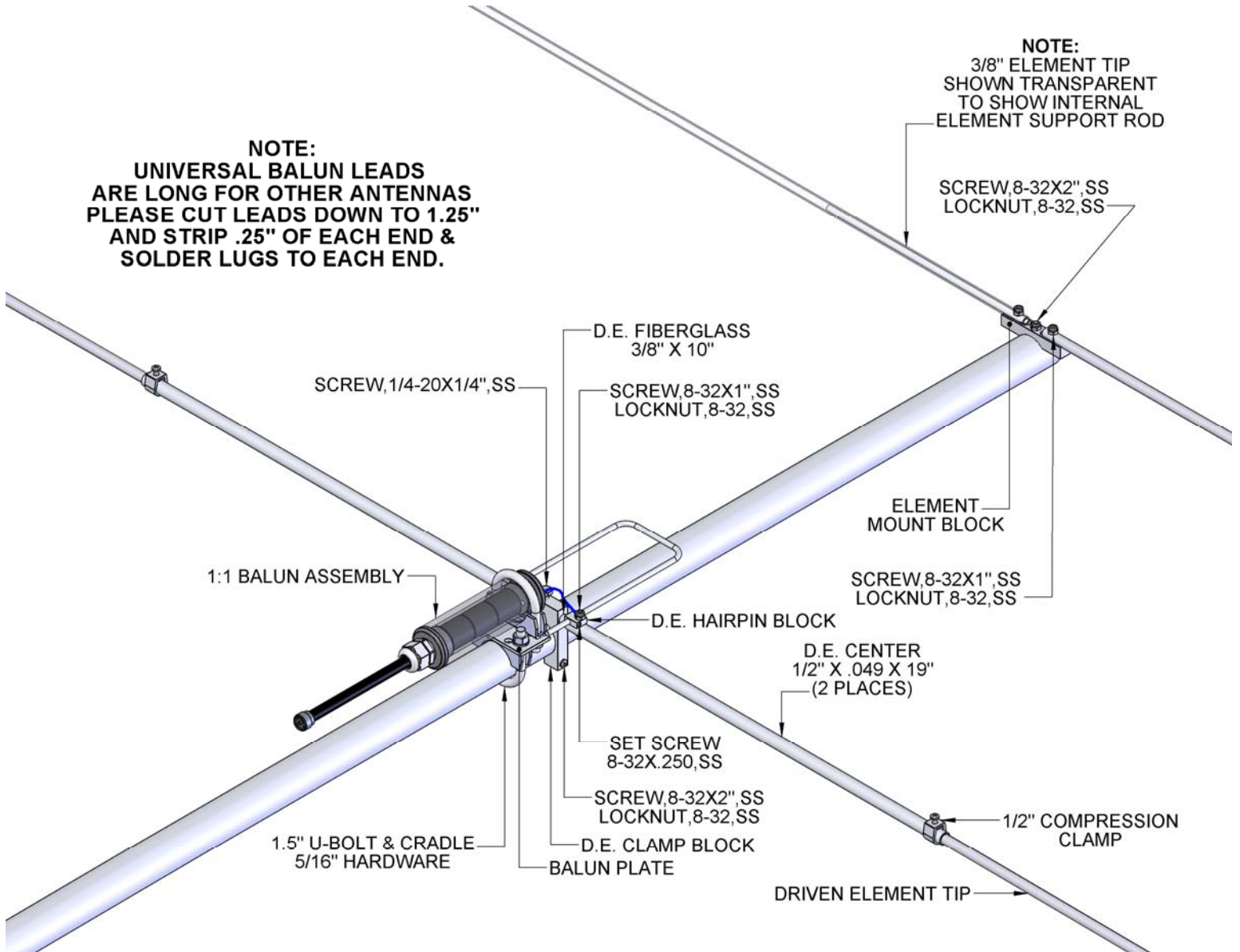

NOTE:
FOR STACKING
PLEASE LOOK FOR PHASING DOTS
ABOVE ONE LEAD.
FOR MORE STACKING INFORMATION
PLEASE CALL THE FACTORY.

GENERIC COMPRESSION CLAMP DETAIL

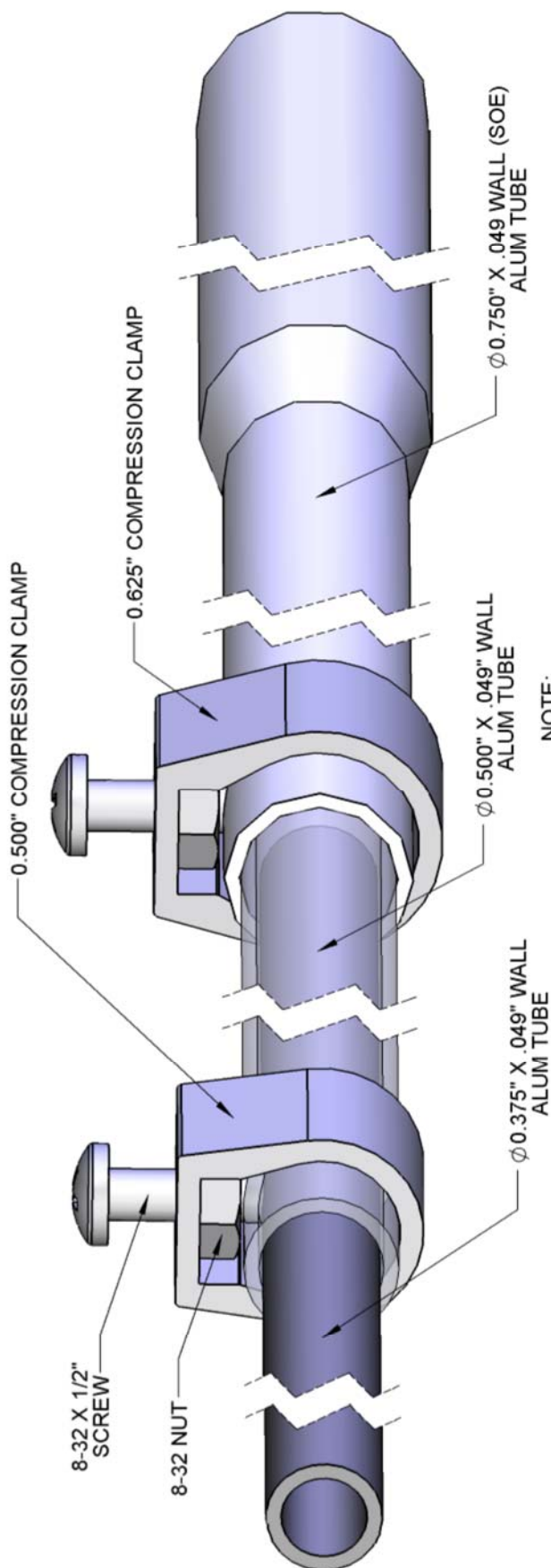

NOTE:
TUBES SHOWN TRANSPARENT
TO SHOW MORE DETAIL

NOTE:
Generic layout to show
how compression clamps work.
Your antenna may have one or the other
or may even have both compression
clamp sizes.

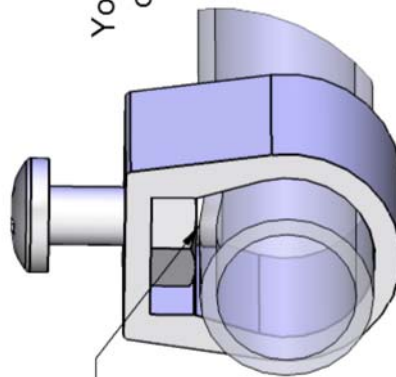

NOTE:
8-32 X 1/2" SCREW
PRESSES ON INNER TUBE

NOTE: INSIDE TUBE NOT SHOWN FOR CLARITY

6M5XHP PARTS & HARDWARE

DESCRIPTION.....	QTY
BOOM SECTION #1: 1.5" X .065 X 60" SOE	1
BOOM SECTION #2: 1.5" X .065 X 60" SOE	1
BOOM SECTION #3: 1.5" X .065 X 60" SOE	1
BOOM SECTION #4: 1.5" X .065 X 45"	1
DE ELEMENT CENTER, .50" X .049 X 19"	2
ELEMENT HALF TUBES, .375" X .049 X SEE CHART	8
DRIVEN ELEMENT TIP, .375" X .049 X 39.188"	2
ELEMENT SUPPORT ROD, 1/4" X 10"	8
HARIPIN ROD, .188" X 16.5"	1
FIBERGLASS DE CENTER, .375" X 10" (M2AFG0017)	1
DE HAIRPIN BLOCK, .50" X .250 X .625"	2
ELEMENT MOUNT BLOCK, .500" X .500 X 3"	4
DE CLAMP BLOCK 1.50" X .500 X 2.626" (M2ADE0094)	1
BALUN PLATE, .125" X 1.5" X 3"	1
BOOM TO MAST PLATE, 4" X .1875 X 6" (M2APT0022)	1
(3) FAIRITE 1:1 VHF BALUN ASSEMBLY (SO-239) (FGBL0700)	1
PENETROX / ZINC PASTE CUP	1
ASSEMBLY MANUAL	1
HARDWARE:	
COMPRESSION CLAMP, 1/2"	2
U-BOLT AND CRADLE, 2"	2
U-BOLT AND CRADLE, 1-1/2"	4
LOCKWASHER, 5/16, SS	16
NUT, 5/16-18, SS	16
BOLT, 1/4-20 X 1/2", SS	1
SCREW, 8-32 X 2", SS	5
SCREW, 8-32 X 1-3/4", SS	6
SCREW, 8-32 X 1", SS	10
SCREW, 8-32 X 1/2", SS	2
SET SCREW, 8-32 X 1/4", SS	2
NUT, 8-32, SS	2
LOCKNUT, 8-32, SS	21
ALLEN HEAD WRENCH, 5/64"	1

M² ANTENNA SYSTEMS, INC.

4402 N. SELLAND AVE.

FRESNO, CA 93722

(559) 432-8873 FAX: 432-3059

www.m2inc.com Email: sales@m2inc.com